



Footprints tell the story

Otters on the move

Dargavel's resident male otter has been busy exploring new water features within the village. The picture, showing the otter prints, was taken within 48 hours of the new burn and waterfall, located at the northern boundary of the development, being constructed. It shows how adaptable and curious otters are and how quickly they find new opportunities for feeding outside of the specially created Otter Park.



Newts ready for the winter

Our team of ecologists found a juvenile newt leaving one of the ponds in the village. It is looking for a safe place to spend the winter in hibernation. During the winter months newts will shelter in holes in the ground, under tree roots or even underneath concrete paving slabs. They start to wake up in early spring, and immediately move back into their breeding ponds.

Bridges to schools

Our Infrastructure Project Manager, Gavin Moran, recently visited Bishopton Primary School to help them with a special project. Gavin, along with John Robinson from Morgan Sindall, who are constructing the new M8 junction on our behalf, were helping the school take part in the Institution of Civil Engineers' Bridges to Schools activity.

Bridges to Schools is a hands-on activity which gives pupils the chance to build a 13m long cable stayed bridge. After building the bridge, pupils get to walk across it. They learned about civil engineering, teamwork and bridges throughout the day and they successfully completed the bridge and even braved walking over it.

Gavin said: "As part of the development of Dargavel Village we have had to build a number of bridges so we felt this would be a good way of engaging the pupils in the project. They got to learn about how we build bridges and how working as a team makes things a lot easier. It was a lot of fun and the pupils were very talented, there are definitely some future civil engineers here."

Miss Burnett, from Bishopton Primary School, said: "We had four classes ranging from P2 to P6 taking part in the Bridges for Schools project. They all had a wonderful time and it was great for them to see engineering in action. Each class did a brilliant job of working together to assemble the bridge and were extremely proud of the finished result. This is an excellent project and we are so grateful to the team for coming in to work with our pupils. I am sure it is a day the children will remember for years to come."



Annual Bishopton Fun Run

Once again, we were delighted to support the annual Bishopton Fun Run by providing funding for the runners' medals. Well done to all that took part.

Have your say

Contact us anytime

We are keen to hear your views on the Dargavel Village development. Send your thoughts to us at:
Georgetown Reception Centre,
Houston Road, Houston PA6 7BG
T: 0800 130 3302
W: www.baesystems.com/bishopton



Bishopton regeneration

Update

Edition 8: autumn 2017



Welcome to the autumn issue of our newsletter.

In the last issue I talked about the excellent progress we have made on the construction works for the M8 junction. I'm pleased to say that we remain on schedule and will have completed phase one of the M8 junction works at the end of October. This includes implementing measures to enable the ground to settle to allow the final construction of new roads and roundabouts. During the settlement period there will be limited site operations meaning you will see little activity on the site for around 18 months.

Over the last 18 months we have seen progress in the delivery of amenity areas and we have recently extended Strawberry Lane and opened up Craighton Park. This completes the first phase of the landscaping and associated works, which includes improvement works to Station Road and Birch Road, completion of Newton Road and the reconstruction of the original factory entrance.

We have also installed energy-efficient LED street lights on Slateford Road, Barrangary Road and Crosshill Road. As we head in to the winter months, we have once again contracted Balfour Beatty to undertake the gritting works within Dargavel Village.

Finally, I was delighted to see a member of my team visiting Bishopton Primary School and engaging with the pupils there, encouraging young people to think about Science, Technology, Engineering and Maths (STEM) subjects. This is something that we are passionate about. We continue to work with the school on some other exciting projects; we'll have more information on that in our next issue.

Once again I'd like to thank you for your continued support.

Jon Gettinby

Development news



Overseeing the development of the new junction

Settlement period has started at the M8 junction site

From the end of October 2017, work on the new M8 junction 29A will take a planned pause to allow the ground to consolidate and settle marking an end to the phase one works. Phase one involved the initial ground and environmental works diversions and the construction of the embankments in preparation for final construction.

All roadworks will be removed from both the A8 Greenock Road and the M8 during this stage.

Allowing the ground to settle is a requirement to ensure it is strong enough to allow the final stage of construction to start. During this settlement period, teams of surveyors will regularly visit the site to monitor progress. BAE Systems will continue to work with Renfrewshire Council and Transport Scotland as our team of expert engineers analyse the settlement results.

Once the ground has settled sufficiently (anticipated to be spring 2019), we will be moving on to phase three. This is the final stage of construction and includes the completion of all works associated with the new junction to enable traffic to access and exit the M8.

Once complete, the new junction will enhance Bishopton's connectivity to the wider region benefiting residents, commuters and the local economy.

Energy efficient street lights

The installation of energy-efficient LED street lights on Slateford Road, Barrangary Road and Crosshill Road has been completed.

The new lights significantly reduce CO₂ emissions and concentrate the light on to the road and footpaths, reducing light pollution in surrounding areas.



The new LED street lights at the top of Slateford Road

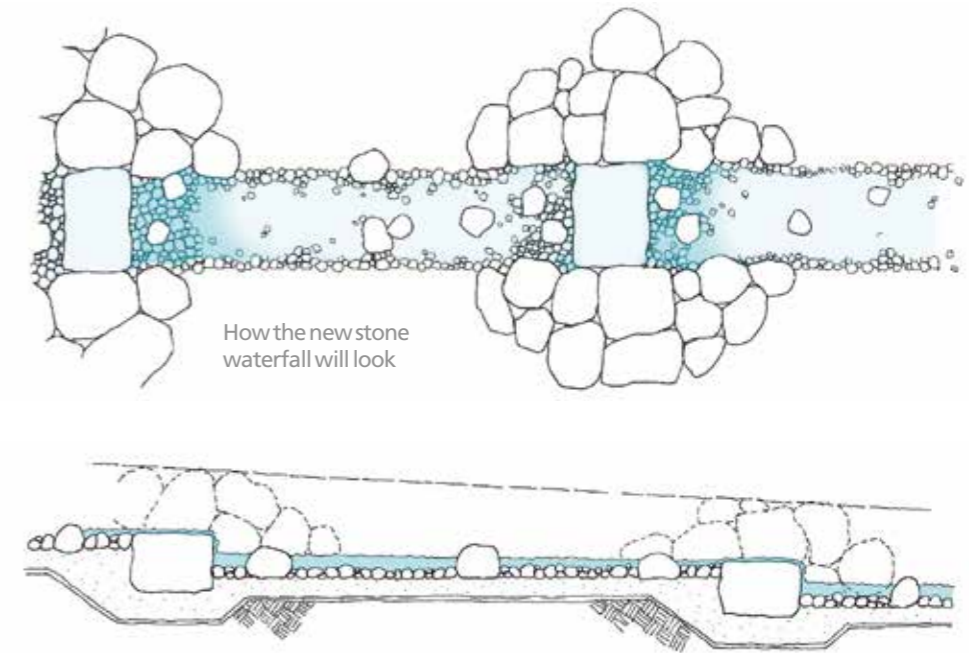

How the new stone waterfall will look

A new and sustainable river environment at Dargavel Village

When the Bishopton Royal Ordnance Factory was built, a number of watercourses that crossed the site were diverted into a network of underground pipes. As part of the ongoing development of Dargavel Village, we are designing and building a new river network through the development using watercourses not seen since the 1930s.

The new river system is part of our sustainable approach to drainage, based on improving water quality and ecological value in addition to improving the amenity of the development providing attractive features and creating new habitats for wildlife.

We have worked with our landscape architects, CASS Associates, and Professor Janet Hooke from Liverpool University, on the design and detailing of the new watercourses for the village. Professor Hooke is an internationally recognised authority on river systems and their conservation.

In addition to the work on the Craigton Burn, we have recently constructed a new burn as part of our phase three remediation works at the northern boundary of the development. This new watercourse flows over a recently constructed stone waterfall which drops around six metres to a pool at the base before continuing through Central Park.

The new river channels will be landscaped to provide high quality river environments and to encourage wildlife. Public paths are also included to allow residents and visitors to enjoy the new water environment.

Investing in shared spaces

Over the summer months we opened Craigton Park, a shared area that can be accessed from Barrangary Road and the recently landscaped, Strawberry Lane, the link path which runs south from Station Car Park to Craigton Park.

Our vision for Dargavel Village centres around the importance of green, open spaces for people to enjoy, and as the development matures we will continue to make investing in community facilities a priority.

The next phase of landscaping work, including planting of trees around the village ponds, will start in over the coming months.